

■ Type H1 Hydraulic-Type Grease Nipples

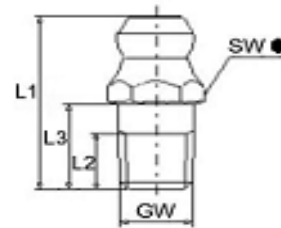

- according to DIN 71412
- straight version A/180°
- standard versions according to DIN are made of steel, case-hardened, zinc-plated and passivated
- with tapered thread
- for other types and materials, please see table, or upon request

GW thread
L1 overall length
L2 thread length
L3 shank length
SW HEX size



(all measures in mm,
thread metric or in inches)

GW	M 5 x 0.8			Ref.- No.:				
L1	L2	L3	SW	Steel	Brass	SST303	SST316L	
15	5.5		7mm HEX ●	1100701	1110701	1120701		

GW	M 6 x 0.75			Ref.- No.:				
L1	L2	L3	SW	Steel	Brass	SST303	SST316L	
15	5.5		7mm HEX ●	1100703	1110703	1120703		
24	6	14	7mm HEX ●	5241056				
24	4	14.5	7mm Hex ●	5241069				

GW	M 6 x 1.0			Ref.- No.:				
L1	L2	L3	SW	Steel	Brass	SST303	SST316L	
13,5	4		7mm HEX ●	5241007	5241101	5241102		
15	5.5		7mm HEX ●	1100704	1110704	1120704	1140704	
17.3	5.6	8.5	7mm HEX ●	5241038				
24	6	14	7mm HEX ●	5241057				
24	6	14	7mm Hex ●	*** 5241059				
29	8,3	19	7mm HEX ●	* 5241060				
41	6	31	7mm HEX ●	5313742				
15	5.5		11mm HEX ●	1101104		1121104		

GW	M 7 x 1.0			Ref.- No.:				
L1	L2	L3	SW	Steel	Brass	SST303	SST316L	
15	5.5		9mm HEX ●	1100905				

GW	M 8 x 0.75			Ref.- No.:				
L1	L2	L3	SW	Steel	Brass	SST303	SST316L	

15	5.5		9mm HEX	●	1100906			
----	-----	--	---------	---	---------	--	--	--

GW	M 8 x 1.0								
					Ref.- No.:				
L1	L2	L3	SW		Steel	Brass	SST303	SST316L	
15	5.5		9mm HEX	●	1100907	1110907	1120907	1140907	
18.5	8.5		9mm HEX	●	5241009				

GW	M 8 x 1.25								
					Ref.- No.:				
L1	L2	L3	SW		Steel	Brass	SST303	SST316L	
15	5.5		9mm HEX	●	1100908	1110908	1120908	1140908	

GW	M 10 x 1.0								
					Ref.- No.:				
L1	L2	L3	SW		Steel	Brass	SST303	SST316L	
15	5.5		11mm HEX	●	1101109	1111109	1121109	1141109	
17.5	7.5		11mm HEX	●	5241074				

GW	M 10 x 1.25								
					Ref.- No.:				
L1	L2	L3	SW		Steel	Brass	SST303	SST316L	
15	5.5		11mm HEX	●	1101110				

GW	M 10 x 1.5								
					Ref.- No.:				
L1	L2	L3	SW		Steel	Brass	SST303	SST316L	
15	5.5		11mm HEX	●	1101111	1111111	1121111	1141111	

GW	M 12 x 1,0								
					Ref.- No.:				
L1	L2	L3	SW		Steel	Brass	SST303	SST316L	
17.5	6.5		14mm HEX	●	1101412				

GW	M 12 x 1,25								
					Ref.- No.:				
L1	L2	L3	SW		Steel	Brass	SST303	SST316L	
17.5	6.5		14mm HEX	●	1101413				

GW	M 12 x 1.5								
					Ref.- No.:				
L1	L2	L3	SW		Steel	Brass	SST303	SST316L	
17.5	6.5		14mm HEX	●	1101414	1111414	1121414		

GW	M 12 x 1.75								
					Ref.- No.:				
L1	L2	L3	SW		Steel	Brass	SST303	SST316L	
17.5	6.5		14mm HEX	●	1101415		1121415	1141415	

GW		M 14 x 1.5		Ref.- No.:				
L1	L2	L3	SW	Steel	Brass	SST303	SST316L	
17,5	6.5		14mm HEX	1101417				

GW		M 14 x 2.0		Ref.- No.:				
L1	L2	L3	SW	Steel	Brass	SST303	SST316L	
17.5	6.5		14mm HEX	1101418				

GW		M 16 x 1.5		Ref.- No.:				
L1	L2	L3	SW	Steel	Brass	SST303	SST316L	
18	7		17mm HEX	1101719				

GW		R 1/8, 1/8 - 28 BSP		Ref.- No.:				
L1	L2	L3	SW	Steel	Brass	SST303	SST316L	
43	6	33 **	9mm HEX	5241070				
15	5.5		11mm HEX	1101156	1111156	1121156	1141156	

GW		R 1/4, 1/4 - 19 BSP		Ref.- No.:				
L1	L2	L3	SW	Steel	Brass	SST303	SST316L	
17.5	6.5		14mm HEX	1101457	1111457	1121457	1141457	
19	8		14mm HEX	5241071				

GW		R 3/8, 3/8 - 19 BSP		Ref.- No.:				
L1	L2	L3	SW	Steel	Brass	SST303	SST316L	
18	7		17mm HEX	1101758		1121758		

GW		1/8" - 27 NPT/PTF		Ref.- No.:				
L1	L2	L3	SW	Steel	Brass	SST303	SST316L	
45	6,5	35 **	9mm HEX	5241076				
65	8	55 **	9mm HEX	5241077				
15	5.5		11mm HEX	1101167	1111167			
17	6,5		11mm HEX				1141167	
17.5	6,5	7.5	11mm HEX	5241024	5241105	5241106		
31	6	21	11mm HEX	5241075				

GW		1/4" - 18 NPT/PTF		Ref.- No.:				
L1	L2	L3	SW	Steel	Brass	SST303	SST316L	
17.5	6.5		14mm HEX	1101468				
19	8		14mm HEX	5241072				
21	9		14mm HEX				1141468	

GW		1/4" - 28 NF/UNF/SAE			Ref.- No.:				
L1	L2	L3	SW	Steel	Brass	SST303	SST316L		
13.5	4		7mm HEX ●	5241054	5241103				
15	5.5		7mm HEX ●	1100737	1110737	1120737			
17.3	5.6	8.5	7mm HEX ●	5241055					
24	6	14	7mm HEX ●	5241058					
29	8.3	19	7mm HEX ●	5241061					
41	6	31	7mm HEX ●	5241080					

GW		1/4"- 26 BSF			Ref.- No.:				
L1	L2	L3	SW	Steel	Brass	SST303	SST316L		
15	5.5		7mm HEX ●	1100744	1110744	1120744			
29	8.3	19	7mm HEX ●	5241062					

GW		1/4" BSW			Ref.- No.:				
L1	L2	L3	SW	Steel	Brass	SST303	SST316L		
15	5.5		7mm HEX ●	1100750					

GW		5/16" - 24 NF/UNF/SAE			Ref.- No.:				
L1	L2	L3	SW	Steel	Brass	SST303	SST316L		
14	4		9mm HEX ●	5241068					
15	5.5		9mm HEX ●	1100938	1110938	1120938			

GW		5/16" - 22 BSF			Ref.- No.:				
L1	L2	L3	SW	Steel	Brass	SST303	SST316L		
15	5.5		9mm HEX ●	1100945					

GW		5/16" BSW			Ref.- No.:				
L1	L2	L3	SW	Steel	Brass	SST303	SST316L		
15	5.5		9mm HEX ●	1100951					

GW		3/8" - 18 NPT/PTF			Ref.- No.:				
L1	L2	L3	SW	Steel	Brass	SST303	SST316L		
18	7		17mm HEX ●	1101769					

GW		3/8" - 20 BSF			Ref.- No.:				
L1	L2	L3	SW	Steel	Brass	SST303	SST316L		
15	5.5		11mm HEX ●	1101146					

GW		3/8" - 24 NF/UNF/SAE			Ref.- No.:				
L1	L2	L3	SW	Steel	Brass	SST303	SST316L		
15	5.5		11mm HEX ●	1101139	1111139	1121139			

GW	3/8" BSW			Ref.- No.:				
L1	L2	L3	SW	Steel	Brass	SST303	SST316L	
15	5.5		11mm HEX ●	1101152				

GW	1/2" - 20 UNF/NF/SAE			Ref.- No.:				
L1	L2	L3	SW	Steel	Brass	SST303	SST316L	
17.5	6.5		14mm HEX ●	1101440				

* unhardened
 ** 2-parts
 ** * cylindrical