

FLUSH-TYPE GREASE NIPPLES - SPECIAL DESIGNS



VERSIONS

The following types are representing only the most commonly used special-type nipples. For individual applications, UMETA manufactures flush-type grease nipples with special equipment in other versions, with respect to the following:

- dimension
- material
- thread size
- thread form (e. g. with tapered thread)
- length

Type DV1



Flush-Type Grease Nipples

- without collar, with slot for screwdriver
- for even mounting without projection
- straight version A/180°
- made of steel, zinc-plated and passivated, with cylindrical thread

GW thread
L1 overall length

(all measures in mm, thread metric or in inches)

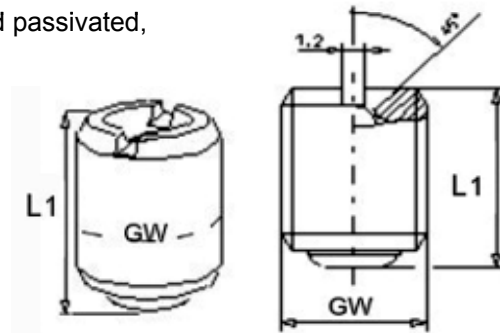

GW	M 8 x 1.0			
	Ref.- No.:			
L1	Steel	Brass	SST303	SST316L
10	5243010		5243069	5243021

GW	M 10 x 1.0			
	Ref.- No.:			
L1	Steel	Brass	SST303	SST316L
10	5243018		5243067	

GW	G 1/8, 1/8 - 28 BSPP			
	Ref.- No.:			
L1	Steel	Brass	SST303	SST316L
10	5243019		5243068	

GW	G 1/4			
	Ref.- No.:			
L1	Steel	Brass	SST303	SST316L
13	5243020			



Flush-Type Grease Nipples Type D3 quattro 90°

- made of steel, zinc-plated and passivated,
with tapered thread

GW thread
L1 overall length
L2 thread length
WL angle length
SW HEX size

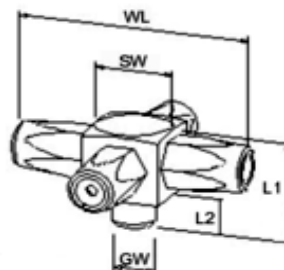

(all measures in mm)

GW					M 6 x 1.0				
					Ref.- No.:				
L1	L2	WL	W	SW	Steel	Brass	SST303	SST316L	
15,5	5,5	33	90°	11 mm SQ.	■	5244185			